

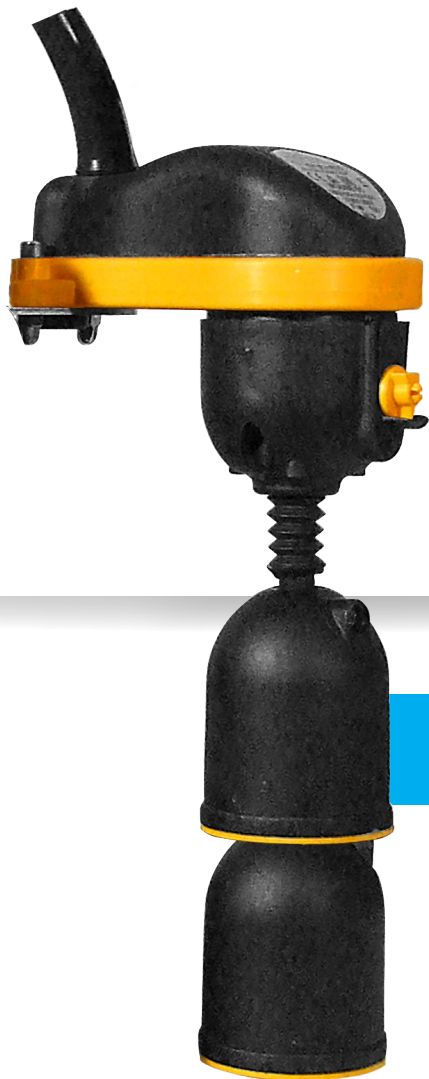

PUMPS AUSTRALIA

BETTER • FASTER • EASIER



VERTICAL FLOAT SWITCH

TECHNICAL DATA

MODEL: VFS05
CODE: 21033

VERTICAL FLOAT SWITCH WITH 5M CABLE

Vertical level regulator suitable for narrow spaces where regular floats do not have enough room to move. At user's will the floating bodies can be moved along the shaft to regulate the minimum and maximum level.

Suitable to control the water level in clean water, rain water, industrial water systems and in systems with water containing chemical substances.

Float switch requires periodic check-ups of its parts.

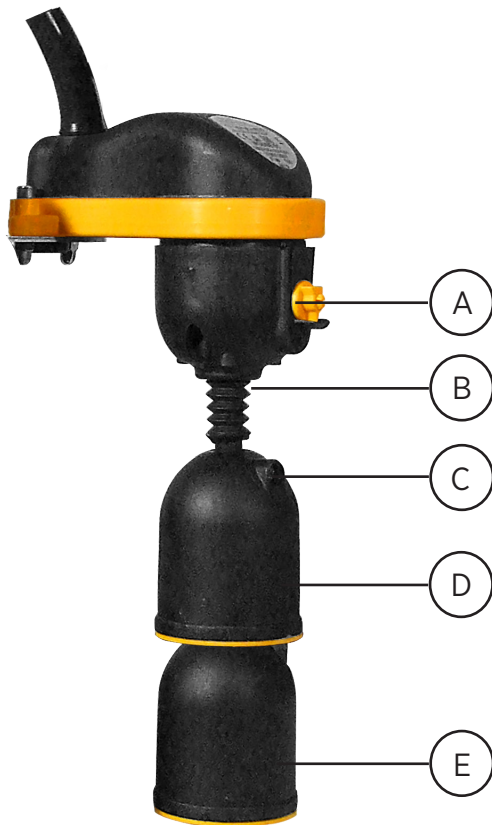

POSITION COMPONENT

POSITION	COMPONENT
A	Automatic Switch
B	Accordian Hose
C	Screw
D	Max Level Float
E	Min Level Float

VERTICAL FLOAT SWITCH VFS05

FEATURE

SPECIFICATIONS

Cable	5m H05 RN-F 3X1 - Ø7.5MM (2 func.)
Casing	Polypropylene
Grommet	EPDM
Power Supply	Max. 10 (8) A, 240V
Depth	Max. 10m
Temperature	Max.+50C°
Protection Grade	IP68
In tank pipe bracket	See Image 1
Pump Bracket for mounting to pump	See Image 2

Image 1



Image 2



DIMENSIONS

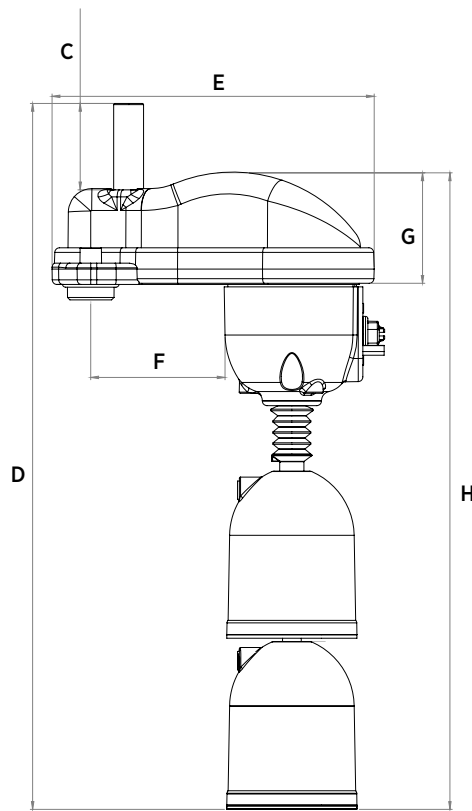
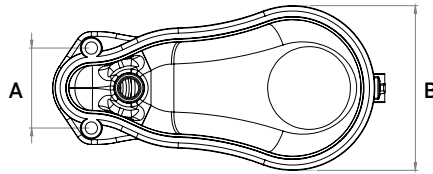

VERTICAL FLOAT SWITCH VFS05

MODEL	DIMENSIONS (MM)							
	A	B	C	D	E	F	G	H
VSF05	33.8	69.6	36.5	273.5	136.1	56.75	46.7	269

OPERATION GUIDE & INSTRUCTION MANUAL

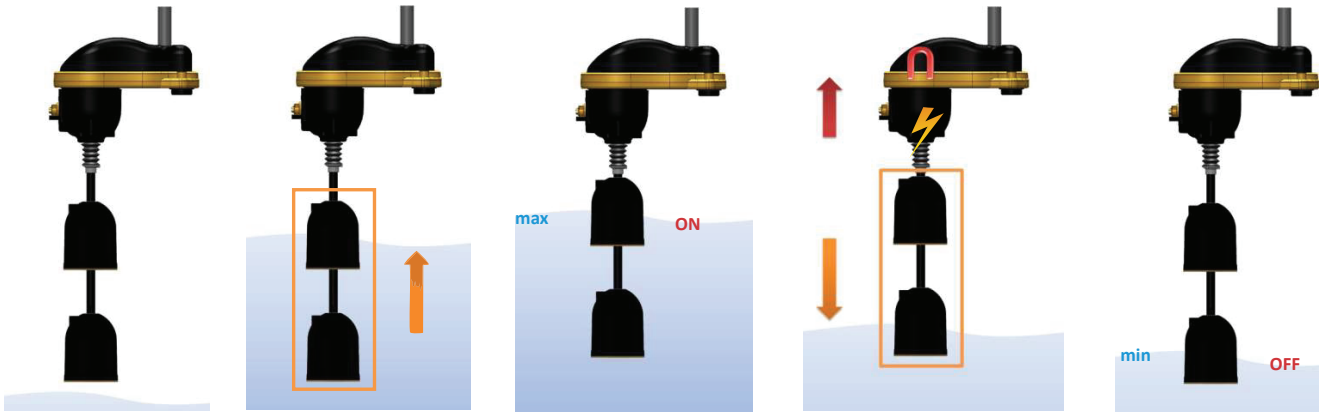

The tank fills up

The water reaches the maximum level and the whole floating body raises

The max level turns the pump ON and the tank drains

The water reaches the minimum level and the weight of the floating body disengages the magnet

The min. level turns OFF the pump

